

VISY-X

VISY-View Printer

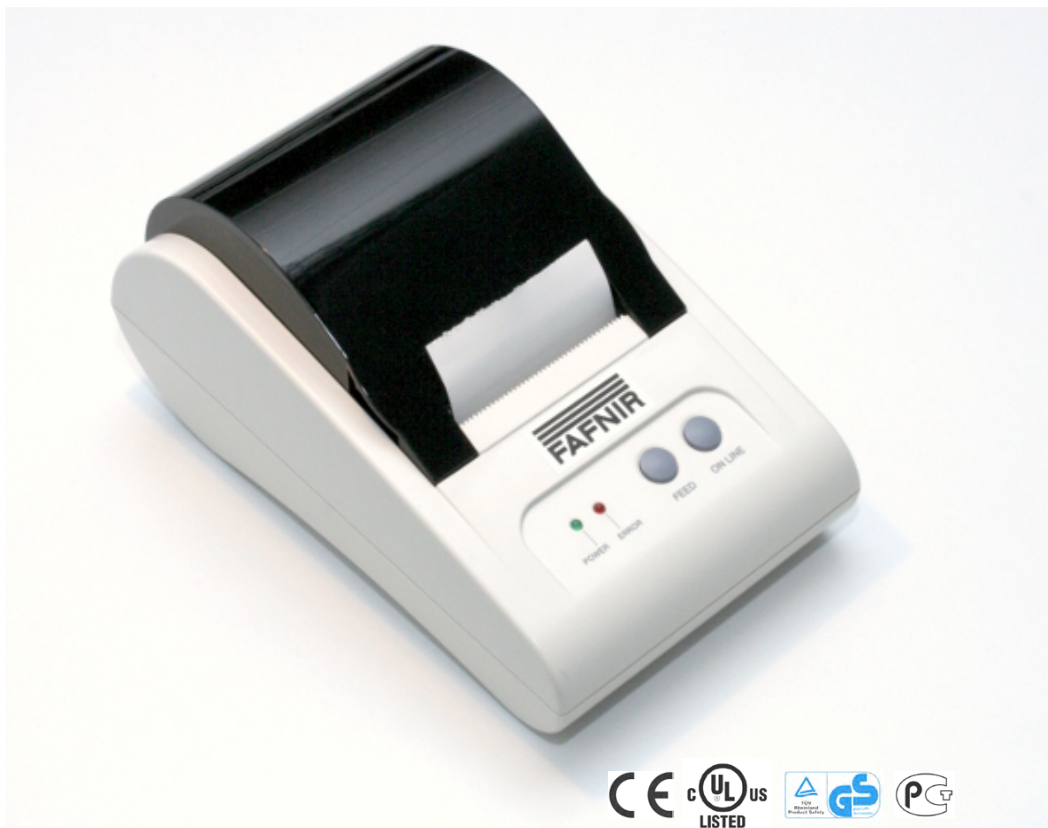

Release: 2016-10
Version: 1
Article No.: 207163



Table of contents

1	Introduction	3
2	Safety precautions.....	3
3	Installation	4
3.1	Connecting to VISY-View.....	4
3.2	Connecting to power.....	4
4	Control panel.....	5
4.1	POWER LED (green)	5
4.2	ERROR LED (red)	5
4.3	FEED button	5
4.4	ON LINE button	5
5	Paper roll installation	6
6	Paper specifications	7
7	DIP switches.....	7
8	Technical Data	8
9	List of figures	8
10	List of tables.....	8

© Copyright:

Reproduction and translation only with the written consent of the FAFNIR GmbH. The FAFNIR GmbH reserves the right to carry out product alterations without prior notice.

1 Introduction

The VISY-View Printer is a low noise thermal printer, which can be used to print out data displayed by the indicator VISY-View of the volume information system "VISY-X".

These data of the VISY-X system can be printed out:

- Configuration
- Tank inventory
- Tank delivery
- Alarms (tank and environmental)

2 Safety precautions

Please keep all safety precautions of electric devices in order to prevent any hazard or material damage. Especially the following regulations must be observed during installation and use of the VISY-View Printer:

- The VISY-View Printer is designed for operation within the VISY-X system only.
- Modifications of the VISY-View Printer are prohibited without the prior consent of the manufacturer.
- The installation and configuration of the VISY-View Printer must be carried out by expert personnel.
- Operators, installers and service technicians must comply with all applicable safety regulations. This also applies to any local safety regulations and accident prevention regulations not stated in this technical documentation.

The safety instructions in this manual are labeled as follows:



If you do not observe these safety instructions, the risk of an accident exists or the VISY-View Printer can be damaged.



Useful information in these instructions, that should be observed, is printed in italics and marked with this symbol.

3 Installation

3.1 Connecting to VISY-View

The communication connection between VISY-View and the VISY-View Printer is done by the delivered serial cable. Proceed as follows to connect the printer with the VISY-View:

- Plug the 25-pole connector securely into the printer's interface connector.
- Plug the other end of the cable into the printer's interface connector of the VISY-View.



Tighten the screws of both connectors to ensure, that the connectors will not be disconnected accidentally.

3.2 Connecting to power

The printer is to be power supplied with the delivered AC/DC adapter only. Connecting the printer to power must to be done as follows:

- (1) Make sure that the printer's power is switched off and that the AC/DC adapter's power cord is unplugged from the electrical outlet.
- (2) Plug the AC/DC adapter's DC cable connector into the printer's power connector.
- (3) Plug the AC/DC adaptor's power cord into the adapter's power connector
- (4) Plug the AC/DC adaptor's power cord into an electrical outlet.
- (5) Turn on the printer using the power switch.



Make sure, that the AC/DC adaptor will not be connected or disconnected from the printer, when the AC/DC adaptor is plugged in the electrical outlet; otherwise you may damage the AC/DC adaptor or the printer.

The following description assumes that the printer is connected completely and under operation, unless not stated expressively.

4 Control panel

The control panel has two indicator LEDs and two buttons.



Figure 1: Control panel

The indicator LEDs provide information about the printer conditions. Under normal circumstances the POWER LED should be constantly on and the ERROR LED should be off. The buttons are used to perform a manual paper feeding and to change between online and offline mode.

4.1 POWER LED (green)

- The POWER LED is on, when power supply is on and the printer mode is online.
- The POWER LED is blinking, when power supply is on and printer mode is offline.

4.2 ERROR LED (red)

- The ERROR LED is blinking slowly, when only a small rest of paper is available.
- The ERROR LED is blinking fast, when the paper is out.

4.3 FEED button

The FEED button is used for the manual paper transport. The button only works if the printer is set into the offline mode. Press the ON LINE button to change between offline and online mode. In the offline mode the POWER LED blinks.

- Press the FEED button once to advance the paper transport one line.
- Press the FEED button constantly to advance the paper transport permanently.

4.4 ON LINE button

The printer must be in online mode to be able to receive data from the VISY-View. If the printer is in offline mode (POWER LED is blinking), press the ON LINE button once to change the mode into online. If the printer is in online mode, the POWER LED lights up permanently.

5 Paper roll installation

To change the paper roll proceed as follows:

- (1) Switch off the printer
- (2) Open the printer cover
- (3) Remove the used paper roll if there is one
- (4) Insert the new paper roll with the paper coming from the bottom
- (5) Pull out a small amount of paper
- (6) Close the printer cover
- (7) Switch on the printer again

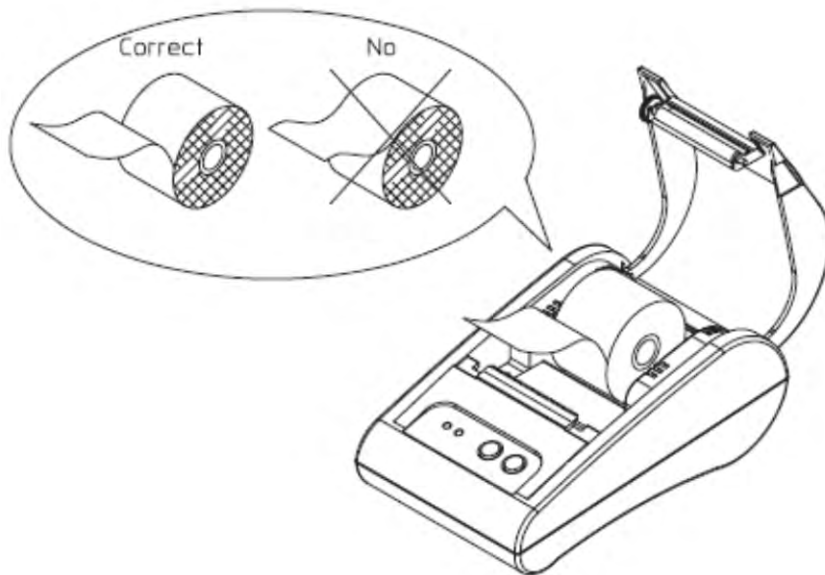

Figure 2: Paper roll installation



Use only paper rolls that match the specifications (see chapter 6).

6 Paper specifications

The following table specifies the paper that can be used for the printer.

Paper type	thermal paper
Paper width	58 mm \pm 0.5 mm
Paper thickness	0.06 ... 0.075 mm
Roll outer diameter	max. \varnothing 60 mm
Roll spool inner diameter	\varnothing 12 mm (0.47")
Roll spool outer diameter	\varnothing 18 mm (0.71")

Table 1: Paper specification



Paper rolls can be ordered from FAFNIR. (Article No. 908615 – 10 pc).

7 DIP switches

During normal printer operation with the VISY-View the factory preset positions of the DIP switches do not need to be changed.

In case of communication problems, you can check for each DIP switch position compared with the following table first. The DIP switches are located bottom side of the printer. Please switch off the printer before changing the DIP switch positions. Otherwise the changes will not be processed by the printer.

Switch	Position
1	OFF
2	OFF
3	ON
4	OFF
5	OFF
6	OFF
7	ON
8	OFF

Table 2: DIP switches

8 Technical Data

Dimensions:	H 90 x W 100 x D 191 [mm]
Ambient temperature:	0 °C ... +40 °C
Power supply:	100 V AC ... 240 V AC, 50 ... 60 Hz, via AC adapter
Printing method:	Thermal line printing
Paper changing:	Easy paper drop in
Paper width:	58 mm ±0.5 mm
Paper roll diameter:	max. 60 mm
Communication:	RS-232 connection to VISY-View

Table 3: Technical Data

9 List of figures

Figure 1: Control panel	5
Figure 2: Paper roll installation	6

10 List of tables

Table 1: Paper specification	7
Table 2: DIP switches	7
Table 3: Technical Data	8